

**JACK**

China No.1

Shanghai stock  
listed



Jack Wechat



Jack Sewing Machine Co.,LTD.



## Computerized Double Needle Lockstitch Machine



JK-58450J

**JACK SEWING MACHINE CO.,LTD.**

No. 15 South Airport Road, Jiaojiang District, Taizhou, Zhejiang, PRC  
TEL: 0086-576-88177782 88177767  
FAX: 0086-576-88177787

E-mail: [sales@chinajack.com](mailto:sales@chinajack.com)  
[www.chinajack.com](http://www.chinajack.com)

# JK-58450J

Computerized Double Needle Lockstitch Machine  
Auto Cornering Large operating space



## 2 Auto Corner Sewing (optional)

Split needle bar, positioning accurately, easy to operate.



## 3 Voice Guide, Factory Reset

Each button has voice reminder, each operation has voice guide. One key can back to factory reset.

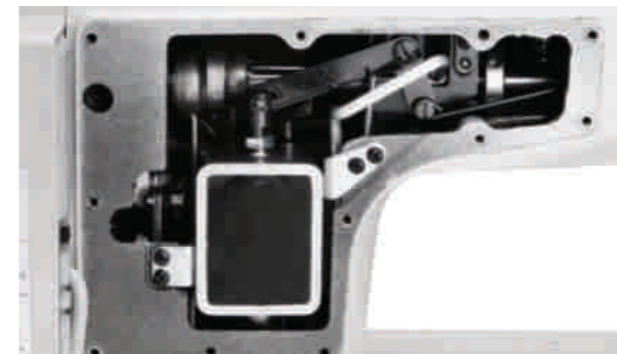

## 4 Built-in Presser Foot Lifter

Easy to operate, save man-power, more stable

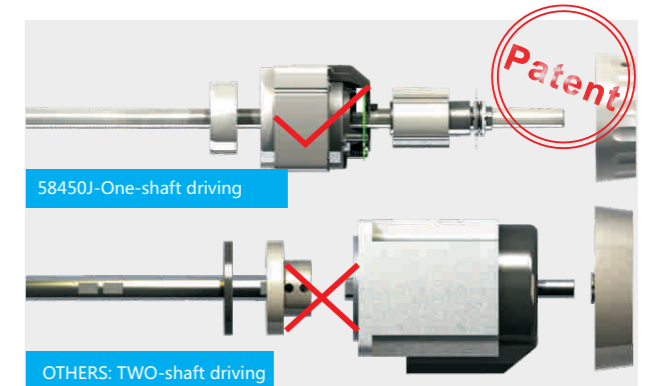

## 5 One Shaft Driving

Reducing the torque, running stably and fast.

## Advantage



Cutting For Thick And Thin Thread

## 1 Straight Knife

For different thickness of thread

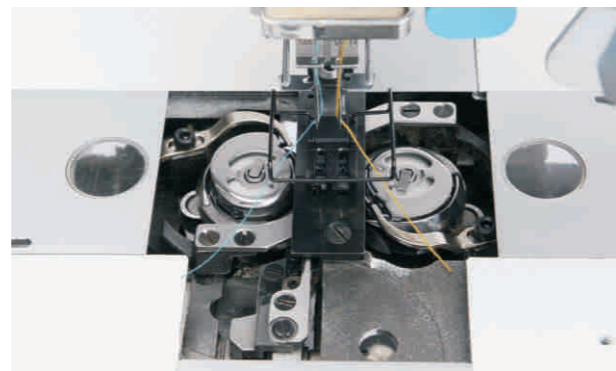

Straight Knife

## Specification

Model	Needle	Stitch Length (mm)	Needle Gauge (mm)	Presser Foot Lifting Height (mm)	Max. Speed (s.p.m)	Application	Function	Auto Corner Sewing	Large Hook	Volume (mm)	Weight (kg)
JK-58420-003/JK-58420-005	DP×5 11-16#/14-22#	4/5	6.4	7-13	3000	Light/Heavy Duty	Straight Stitch			725×320×675	43/53.5
JK-58450-003/JK-58450-005	DP×5 11-16#/14-22#	5	6.4	7-13	3000	Light/Heavy Duty	Corner Stitch			725×320×675	43/53.5
JK-58720-003/JK-58720-005	DP×5 11-16#/14-22#	7	6.4	7-13	3000	Light/Heavy Duty	Straight Stitch		√	725×320×675	43/53.5
JK-58750-003/JK-58750-005	DP×5 11-16#/14-22#	7	6.4	7-13	3000	Light/Heavy Duty	Corner Stitch		√	725×320×675	43/53.5
JK-58420J-403E/JK-58420J-405E	DP×5 11-16#/14-22#	4/5	6.4	7-13	3000	Light/Heavy Duty	Straight Stitch			725×320×675	53/63
JK-58450J-403E/JK-58450J-405E	DP×5 11-16#/14-22#	5	6.4	7-13	3000	Light/Heavy Duty	Corner Stitch			725×320×675	53/63
JK-58450J-413E/JK-58450J-415E	DP×5 11-16#/14-22#	5	6.4	7-13	3000	Light/Heavy Duty	Corner Stitch	√		725×320×675	53/63
JK-58720J-403E/JK-58720J-405E	DP×5 11-16#/14-22#	7	6.4	7-13	3000	Light/Heavy Duty	Straight Stitch		√	725×320×675	53/63
JK-58750J-403E/JK-58750J-405E	DP×5 11-16#/14-22#	7	6.4	7-13	3000	Light/Heavy Duty	Corner Stitch		√	725×320×675	53/63
JK-58750J-413E/JK-58750J-415E	DP×5 11-16#/14-22#	7	6.4	7-13	3000	Light/Heavy Duty	Corner Stitch	√	√	725×320×675	53/63

Note: 1. E is computerized type: auto thread trimming, auto reverse, auto presser foot lift, auto thread wipping are equipped as standard.  
Electronic thread tension is optional. Straight stitch: 103/105; Corner stitch 103 105 113 115.  
2. Optional needle gauge: 1/8 (3.2), 3/16 (4.8), 1/4 (6.4), 5/16 (7.9), 3/8 (9.5), 7/16 (11.1), 1/2 (12.7), 5/8 (15.9), 7/8 (22.2), 1 (25.4)。